

Installation Instructions

RollEase Skyline Single Shade System - Open roll with or without groover valance

CBM Roller Shades: Your roller shade package contains brackets and screws for mounting the shade in any position on the window. The package should display a label that specifies the corresponding room name and window opening number as well as the mount option (inside/exact/outside).

Tools needed: Cordless drill with #8 Robertson drive attachments, standard flat head screwdriver, tape measure & pencil.

Parts included: Installation brackets, installation bracket covers (outside mount only), groover valance installation brackets (optional/if applicable) & installation screws.

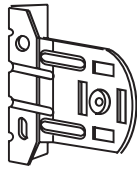

Installation bracket
Open roll or crown/groover
valance



Bracket cover
Outside mount only

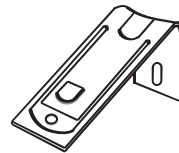

L-shaped installation bracket
Crown//groover valance only



Installation screws

1 - Mount the brackets: Attach the brackets to the window frame moulding, wall or ceiling. Brackets are universal so clutch may be mounted on either side. Note: If sharing a bracket between two shades, bracket can only be shared between a clutch and a pin end and not clutch-to-clutch or pin end-to-pin end. Important: If you purchased your roller shades with groover/crown valance (optional) and shades are being installed inside a window frame, the valance must be drilled into the window frame prior to the installation of brackets (figure 1.1).

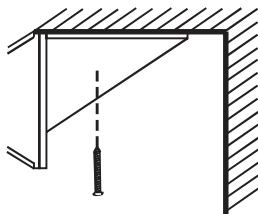

1.1 Groover/crown valance
installation

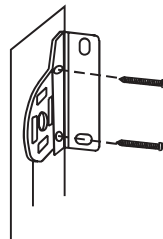

Inside of window frame

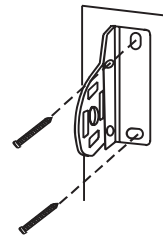

Wall or front of window
moulding

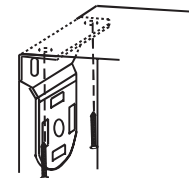

Ceiling or top of window
frame

2. Install the shade: Make sure the shade is rolled all the way up. Insert the spring loaded pin end into the centre hole of the bracket (note that this bracket is opposite to the control side, figure 2.1). Keeping the pin end secured in its bracket, insert the hook arms on the clutch straight into the two hook arm receiver holes on the control end bracket (figure 2.2). Once the two hook arms are through the holes, gently pull down on the clutch until the two hook arms have locked securely to the bracket. The bottom of the clutch should always point straight down.

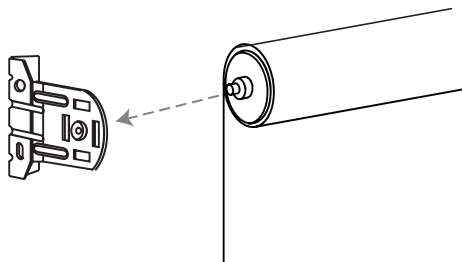

2.1 Installing the pin end

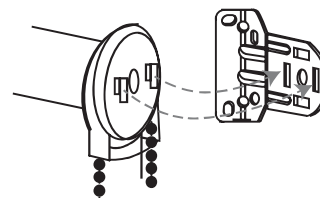

2.2 Locking the clutch

Installation Instructions

3 - Install the bracket covers (optional for outside mount): Bracket covers are slid over the bracket until snapped into position.

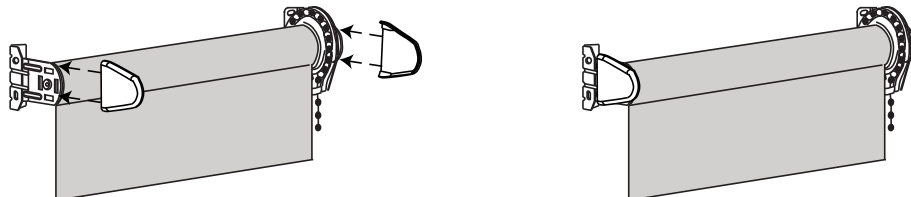

4 - Install the groover/crown valance for outside mount roller shades: For outside mount roller shades, the groover or crown valance is installed after installing the roller shade. Each valance requires a minimum of two brackets. Make sure to leave at least 1/2" clearance above the roller shade brackets. Each bracket must be mounted at least 6" from the edge. Use a pencil to mark the position for L-shaped brackets before drilling them into the wall. Using a level for this step is highly recommended. Finally mount the L-shaped brackets using two screws per bracket. The groover or crown valance can now be installed by sliding into the notch on L-shaped brackets. See illustration below.

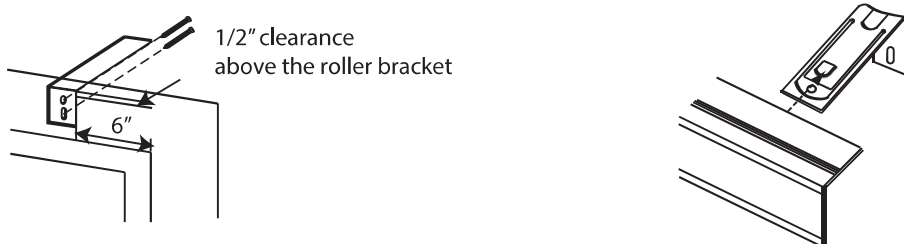

5. Install the tension device: The tension device reduces the hazards of strangulation and entanglement of young children by limiting access to control chain. It must be installed for the shade to be operable. Anchor the tension device, that is attached to the shade's control chain, to the window frame or wall so that young children cannot put the chain around their necks. To install, lower the shade all the way down, hold the tension device upright as shown in the diagram. Position the tension device on the window frame or the wall so that tension device and control chain do not interfere with raising or lowering of the shade. Fasten the screws through the holes to secure the tension device.



Cleaning: CBM roller shades can be cleaned or dusted with a feather duster, soft cloth or an appropriate vacuum suction attachment. Do not use cleaning liquids or detergents. Use of such chemicals will void your warranty.



WARNING/MISE EN GARDE

Young children can **STRANGLE** in cord and bead chain loops. They can also wrap cords around their necks and **STRANGLE**.

Always keep cords and bead chains out of children's reach.

Move cribs, playpens, and other furniture away from cords and bead chains. Children can climb furniture to get to cords.

Attach tension device to wall or to floor. This can prevent children from pulling cords and bead chains around their necks. Fasteners provided with the tension device may not be suitable for all mounting surfaces. Use appropriate anchors for the mounting surface conditions.

For more safety information: 1-866-662-0666