

ROLLER SHADES
EASY SPRING SKYLINE

Installation Manual v1.1



#cbmblinds



CBM

Assembly Parts:

OPEN ROLL:

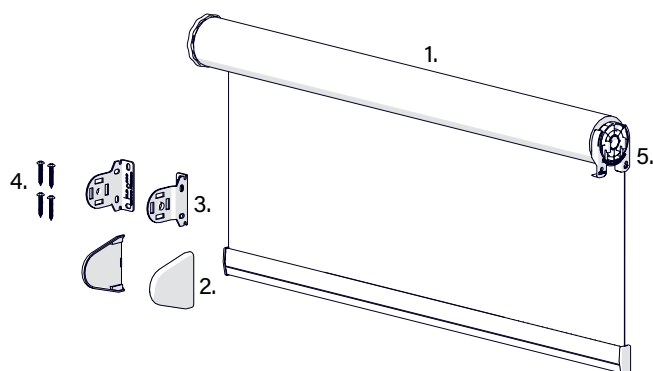

- 1. Shade Assembly
- 2. Bracket covers (outside mt only)
- 3. Mounting brackets
- 4. Installation screws
- 5. Pre-Tension Retaining Clip*

CASSETTE SYSTEM:

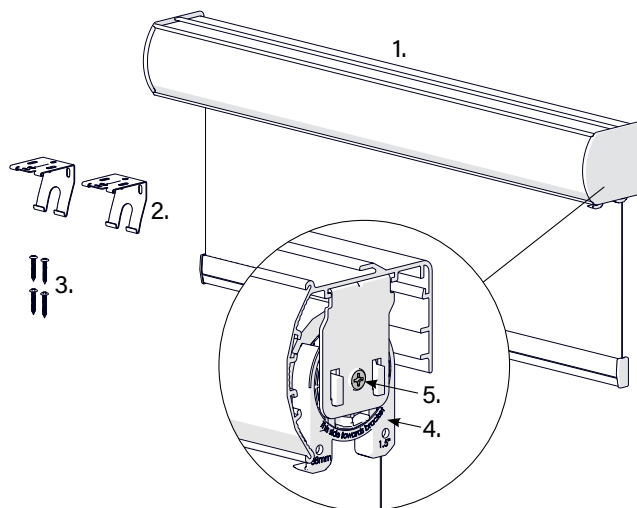

- 1. Shade Assembly
- 2. Mounting brackets (as required)
- 3. Installation screws
- 4. Pre-Tension Retaining Clip*
- 5. Counter Sunk Screw**

The clip must be removed before shade operation.

The screw is used to secure the head to the bracket during transportation of C100, C120 and C95 mounting rails and should be removed before installation.

Tools Needed:



Pencil

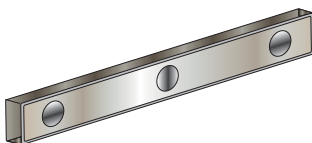

Level

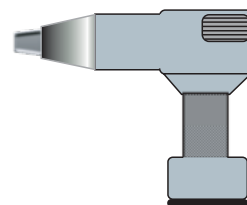

Cordless Drill

Bracket Installation:

MOUNTING BRACKETS:

Ensure top of installation space is level. Install brackets to wall/ceiling using appropriate fasteners to suit application.

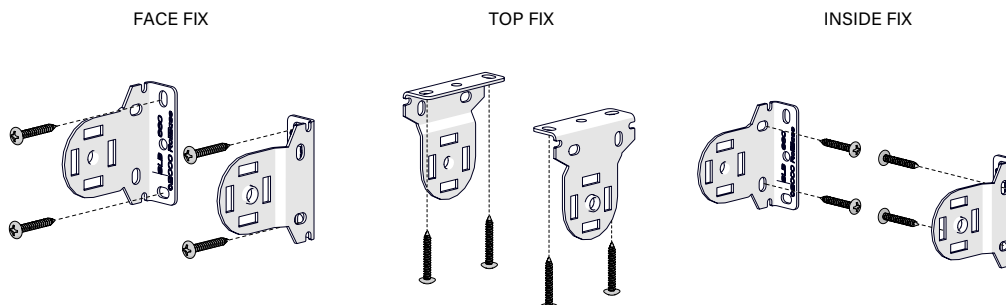

SHADE ORIENTATION:

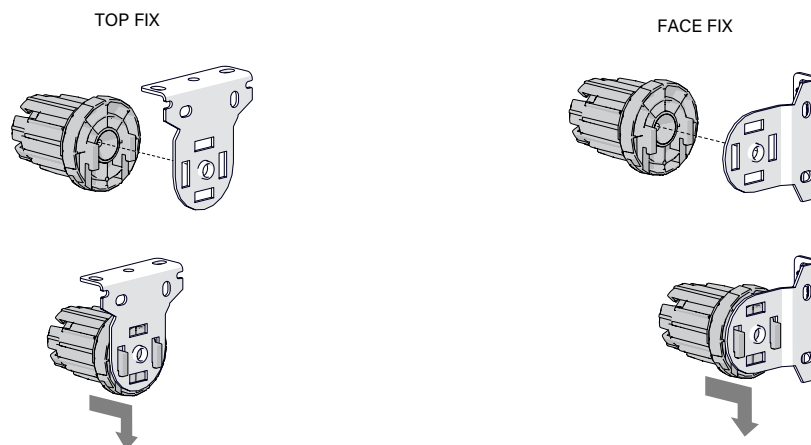

Shade Installation:

Insert limiter end into bracket first.

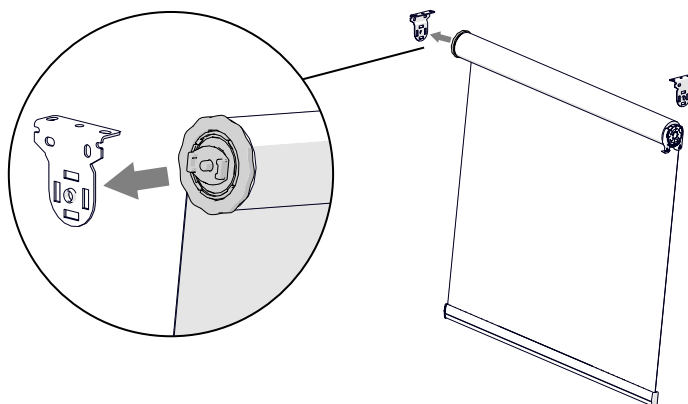

Shade Installation (continued):

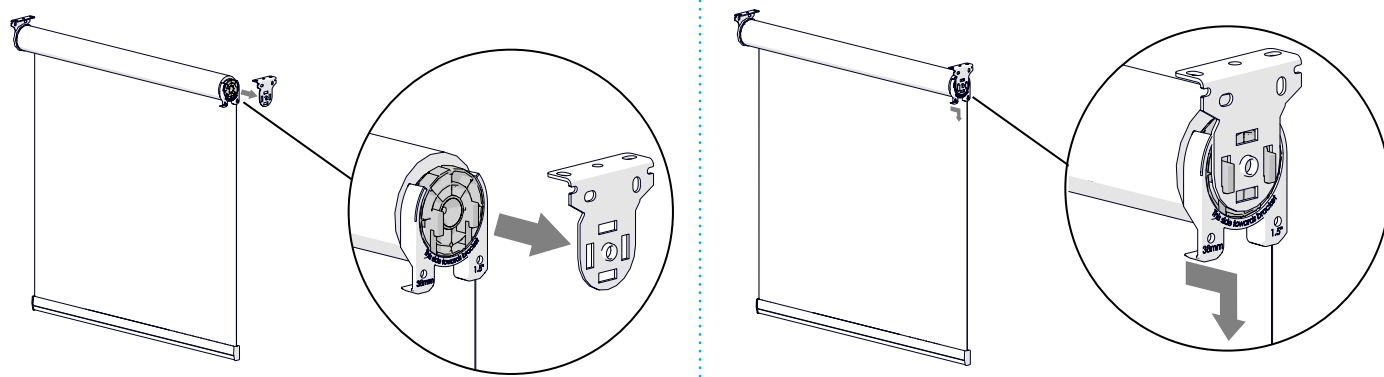

Remove Pre-Tension Retaining Clip:

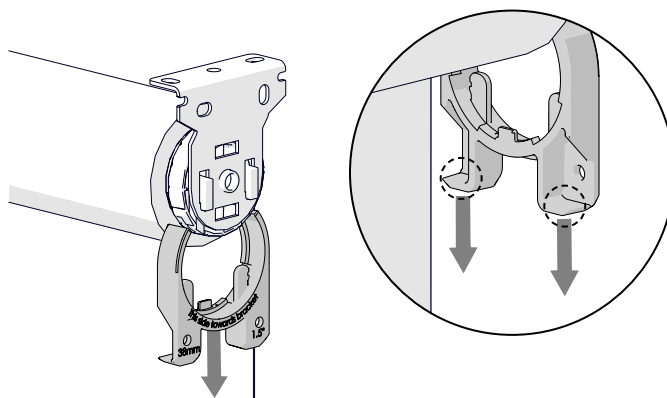

FOR CASSETTE SYSTEM ONLY:

REMOVE CLIP

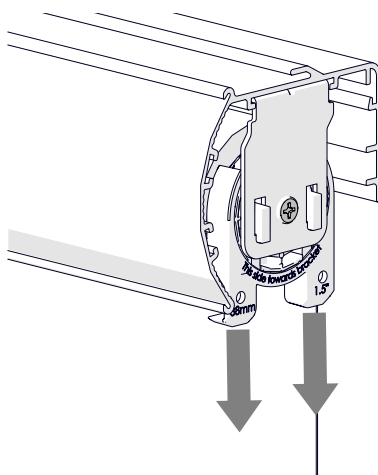

REMOVE SCREW

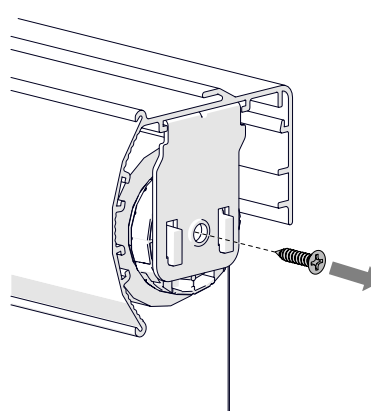

Pre-tension Check:

Check functionality of pre-tensioned shade as shown below:

Pull bottom rail down to bottom location

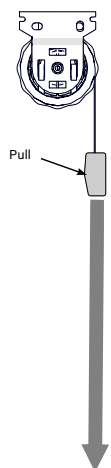

Shade will raise within range indicated below to be locked and provide a 'release allowance' for raising the shade

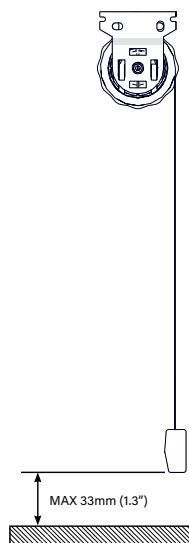

Tug bottom rail (shade will automatically rise)



If bottom rail rises at the desired speed, correct number of pre-turns have been assigned.

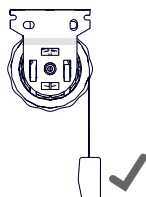

If shade stops midway or slows significantly, insufficient pre-turns have been applied.

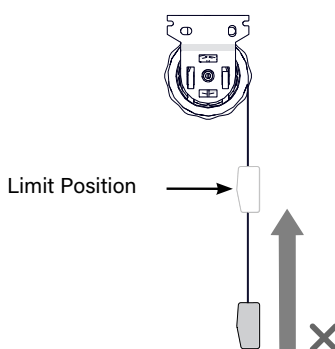

If shade operates too fast, too many pre-turns have been applied.

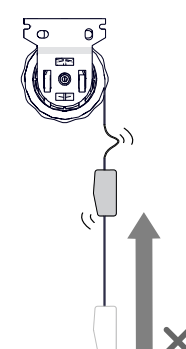

Adding or Removing Pre-Turns:

Before removing the shade, ensure the shade is lowered slightly in its locked position. Shade must not be resting on top limit. This is to prevent the spring from loosing the pre-tension when removing the shade from brackets.

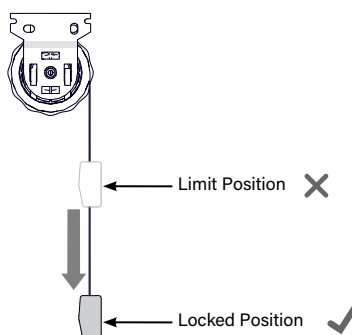

Adding or Removing Pre-Turns (continued):

ADDING PRE-TURNS

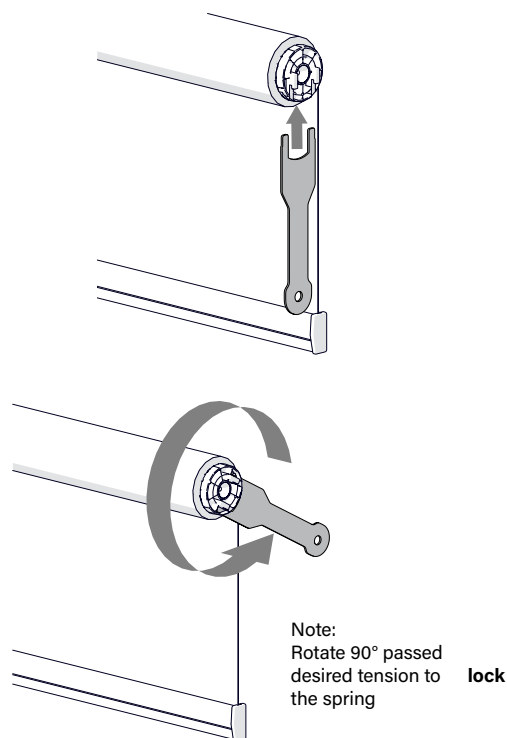

Right hand standard roll control shown as example.

REMOVING PRE-TURNS

Note:
Rotate 45° passed desired tension to the spring **unlock**

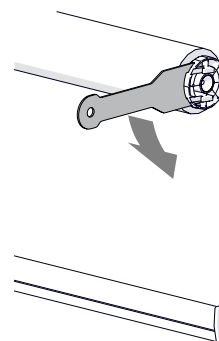

Gently release spring head whilst holding the shade firmly as the spring tension unwraps itself (Spring head will spin in the opposite direction of pre-tensioning)

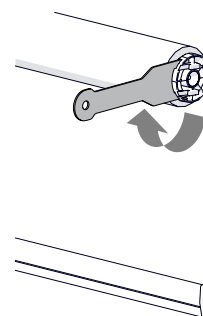

To lock the pre-tension, rotate in the pre-tension direction slightly and then allow the head to untension slightly and lock.

Adjusting the Top Limit:

Ensure shade is fully raised. To lower the top limit position rotate limiter head so that the shade moves down.

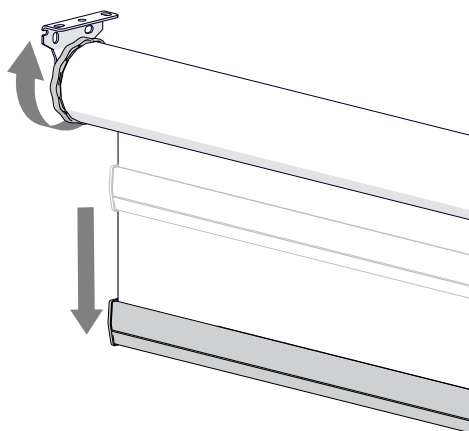

To raise the top limit position rotate limiter head so that the shade raises. The shade must not be locked by the spring to allow bottom bar to move up.

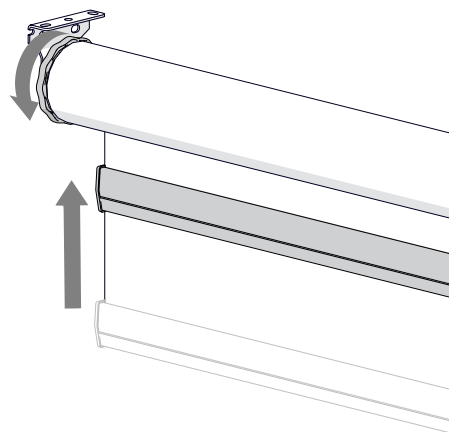

Test Limits & Shade functionality:

Operate shade up and down.

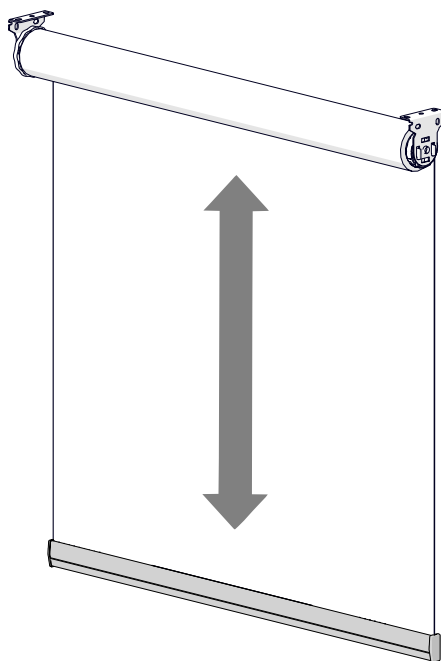
Troubleshooting:

PROBLEM	CAUSE	SOLUTION
1. Cannot find upper limit	Limit set incorrectly	<ol style="list-style-type: none"> 1. Allow shade to rise fully 2. If the bottom rail is too high touching the brackets then wind limit adjustment wheel in the direction that would lower the shade. When the shade start to lower this indicates the limit has been engaged. 3. Use limit adjustment wheel to raise or lower limit as required.
2. Shade falls	Connector on wrong end	Remove and reinstall connector on the other end.
	No pre-turns	Add pre-turns.
3. Shade rises too quickly	Too many pre-turns	Remove pre-turns.
4. Shade does not rise	Control is not fully engaged	Remove control and check booster assembly
	No pre-turns	Add pre-turns.